

Hook Riggings & Connecting Link



Ableforge Greenline Riggings

Copyright 2020 Ableforge Mfg Inc.
 All Rights reserved



Model: MLW



MASTER LINK MLW

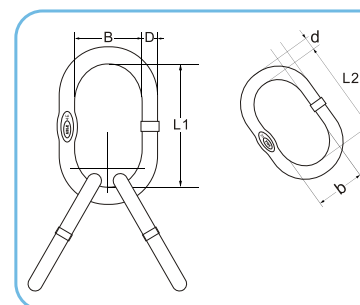
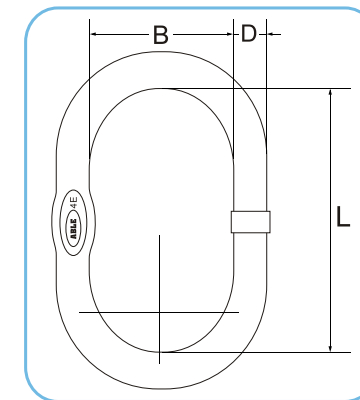

- High grade Alloy Steel (Quenched and Tempered) material
- Design Factor of 4 to 1 for chain and 5 to 1 for wire rope.
- Individually Proof Tested to 2.5 times the Working Load Limit (4:1), unless otherwise noted, with certification.
- Each link has a Product Identification Code (PIC) for material traceability, along with the size and the manufacture mark.
- Larger inside width and length for use with thimble.
- Fatigue rated at 1.5 times the WLL with 20,000 cyclic test

Model: MLA



SUB MASTER LINK MLA

■ Use with 1 leg or 2 legs alloy chain grade 80

ALLOY MASTER LINK GRADE 80 WELDED TYPE: MLW

Product code	1 leg use chain dia. (mm)	2 leg use chain dia. (mm)	Size (D) mm	L mm	B mm	WLL 4:1 ton	weight kg
MLW-07-06	7	6	13	110	60	1.60	0.34
MLW-08-07	8	7	16	110	60	2.12	0.54
MLW-10-08	10	8	18	135	75	3.15	0.83
MLW-13-10	13	10	22	160	90	5.30	1.47
MLW-16-13	16	13	26	180	100	8.20	2.19
MLW-18-16	18	16	32	200	110	11.2	3.92
MLW-20-18	20	18	36	260	140	14.0	6.28
MLW-22-20	22	20	40	300	160	17.0	8.96
MLW-26-22	26	22	45	340	180	21.2	12.90
MLW-32-26	32	26	50	350	190	31.5	16.55

■ Use with 3 legs or 4 legs alloy chain grade 80

ALLOY MASTER LINK ASSEMBLY GRADE 80 WELDED TYPE: MLA

Product code	Chain dia. (Mm)	Size (D) mm	L1 mm	B mm	d mm	b mm	L2 mm	WLL 4:1 ton	weight kg
MLA-06	6 or 7	18	135	75	13	38	60	3.15	1.24
MLA-08	8	22	160	90	16	34	70	4.25	2.21
MLA-10	10	26	180	100	18	40	85	6.70	3.24
MLA-13	13	32	200	110	22	50	115	11.2	6.09
MLA-16	16	36	260	140	26	65	140	17.0	9.98
MLA-18	18	40	300	160	30	140	270	20.0	19.01
MLA-20	20	45	340	180	32	100	180	22.0	20.24
MLA-22	22	50	350	190	36	100	180	31.5	25.00



ABLEFORGED ALLOY STEEL SAFETY HOOKS

The unique design of the Ableforge Safety Hook allows it to be easily closed with one hand, or will close itself when the load is engaged. Once under load, it will not disengage even if the load is temporarily set down. When the load is released, the latch is simply opened by pressing the release trigger, and stays open, making the hookup very easy.

Eye Safety Hook



Model: HSE

Technical Features

- Material is high grade alloy steel (quenched and tempered)
- Used with alloy chain grade 80 for lifting application
- Marked with Brand, WLL, Batch No. and Size
- 100% 2.5 times of capacity proof load tested
- Ultimate load is 4 times of capacity
- Fatigue rated is 1.5 times the WLL at 20,000 cycles
- Lock Latch provides Automatic Locking when Hook is loaded

Clevis Safety Hook



Model: HSC



ABLEFORGED ALLOY SWIVEL HOOK, CONNECTING LINK

This Swivel hooks have all the features of an Ableforge Safety Hook, but with the added bonus of its swivel function. The swivel assists in the removal of sling leg twist, making it particularly suitable for high-rise lifting. The Able C Link's simple design allows instant assembly, dismantling and reassembly of dependably safe slings. Assembly only one chain or fitting to each C link body half. When reassembly a C link, we recommend you use a new pin and stud assembly. These are inexpensive and readily available.

Swivel Hook



Model: HSA

Technical Features

- Material is high grade alloy steel (quenched and tempered).
- Rated for both chain grade 80 and wire rope for lifting application.
- Positive Lock Latch is Self-Locking when hook is loaded.
- Marked with ABLE, traceability, WLL, Batch No. and Size.
- 100% 2.5 times of capacity proof load tested.
- Ultimate load is 4 times of capacity.
- Fatigue rated is 1.5 times the WLL at 20,000 cycles.

Connecting Link



Model: LCT

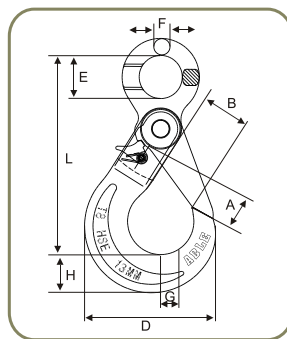

ALLOY EYE SAFETY HOOK GRADE 80 TYPE: HSE

Product Code	For GR80 Chain Dia. (mm)	L mm	A mm	B mm	D mm	E mm	F mm	G mm	H mm	WLL 4:1 Ton	Weight kg
HSE 006	6	107	28	28	73	21	10.5	15	20	1.2	0.50
HSE 008	7,8	136	31	36	91	25	12	20	26	2.0	0.88
HSE 010	10	168	48	45	106	35	15	26	30	3.2	1.58
HSE 013	13	206	60	52	142	41	20	33	40	5.4	3.00
HSE 016	16	254	73	63	170	50	23	38	51	8.2	5.90
HSE 020	18,20	278	77	85	187	64	27	50	56	12.5	7.00
HSE 022	22	319	90	76	204	72	30	52	65	15.0	12.3

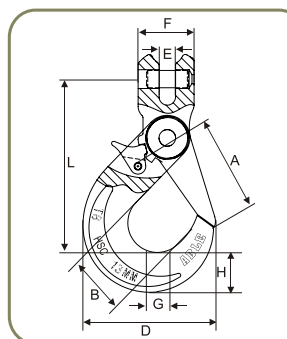

ALLOY CLEVIS SAFETY HOOK GRADE 80 TYPE: HSC

Product Code	For GR80 Chain Dia. (mm)	L mm	A mm	B mm	C mm	D mm	E mm	F mm	G mm	H mm	WLL 4:1 Ton	Weight kg
HSC 006	6	99	35	26	7.8	73	8.5	32	15	20	1.2	0.44
HSC 008	7,8	117	39	36	9.2	91	9	37	20	26	2.0	0.80
HSC 010	10	140	48	44	13.2	107	12	47.5	26	30	3.2	1.38
HSC 013	13	180	60	52	16.3	142	15	60	33	40	5.4	2.81
HSC 016	16	225	65	63	20.2	166	18	77	38	51	8.2	6.00
HSC 020	18,20	238	85	76	24.3	186	25	77	50	55	12.5	7.25
HSC 022	22	277	83	80	28.2	204	25.5	98	52	67	15.0	12.8

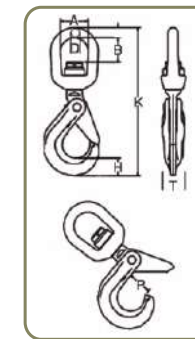

ALLOY SWIVEL SAFETY HOOK TYPE: HSA

Product Code	For GR80 Chain Dia. mm	K mm	P mm	B mm	A mm	D mm	T mm	H mm	WLL 4:1 Ton	Weight kg
HSA 006	6	149	29	25	33	12	15	20	1.2	0.70
HSA 008	7,8	186	34	29	36	14	20	26	2.0	1.15
HSA 010	10	220	44	34	42	16	26	30	3.2	1.86
HSA 013	13	267	52	41	50	22	34	40	5.4	3.51
HSA 016	16	328	63	58	70	24	41	51	8.2	7.30
HSA 020	18,20	377	85	63	72	26	48	55	12.5	10.4
HSA 022	22	466	76	98	97	33	49	67	15.0	17.5

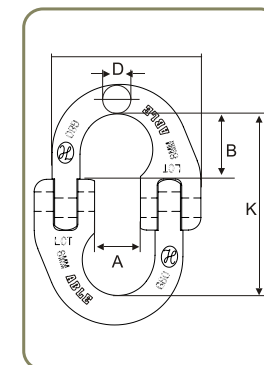

ALLOY CONNECTING LINK GRADE 80 TYPE: LCT

Product Code	For GR80 Chain Dia. mm	K mm	A mm	D mm	B mm	WLL 4:1 Ton	Weight kg
LCT 006	6	44	15	7	17	1.2	0.08
LCT 007	7	55	20	8	20	1.5	0.14
LCT 008	8	59	18	9	22	2.0	0.16
LCT 010	10	68	25	12	26	3.2	0.30
LCT 013	13	87	30	16	35	5.4	0.65
LCT 016	16	108	36	19	38	8.2	1.15
LCT 020	18,20	122	42	23	46	12.5	2.10
LCT 022	22	142	49	26	60	15.0	2.87
LCT 026	26	158	57.5	31	62	21.2	4.50
LCT 032	32	205	67.5	38	79	31.5	8.21



ABLEFORGED ALLOY STEEL GRAB HOOKS

with its reinforced saddle for firmer hookups, less wear and with its nearly round section to resist or bending. The **ABLE Grab Hook** is particularly suitable for back - hooking.

Clevis Grab Hook



Narrow gap allows for full engagement in hook to prevent slip-off

Technical Specialities

- Material is high grade alloy steel (quenched and tempered)
- Used with alloy chain grade 80 for lifting application
- Embossed with ABLE Traceability code, WLL & Product Code.
- Working load limit is 4:1
- Proof load is 2.5 times of work load Limit
- Fatigue rated is 1.5 times the WLL at 20,000 cycles
- Clevis opening only allows correct size of Chain to be fitted
- Narrow gap allows for full engagement in hook to prevent slip - off

Eye Grab Hook



No reduction of working load limit, thanks to supporting wings which prevent chain link deformation.

Model: HGC

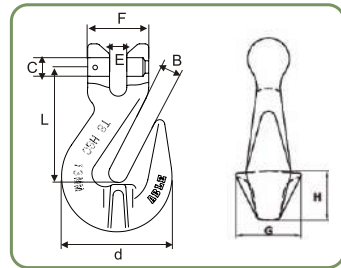

Alloy Clevis Grab Hook Grade 80 Type: HGC

Product Code	For GR80 Chain Dia. (mm)	L mm	B mm	C mm	D mm	E mm	F mm	G mm	H mm	WLL 4:1 Ton	Weight kg
HGC 006	6	45	8	7.6	42	8	32	21.5	17.7	1.2	0.20
HGC 008	7,8	53.5	10.8	9.0	53	9.5	35	33.5	19	2.0	0.30
HGC 010	10	75	13.5	12.8	71	12.5	42.5	46	29	3.2	0.73
HGC 013	13	91	16.5	15.8	90	15	53	57.5	43	5.4	1.66
HGC 016	16	100	19.2	20.0	113	18.5	65	74	46	8.2	2.80
HGC 020	18,20	135	24	24.3	143	23	77	74	56	12.5	5.00
HGC 022	22	153	27	26.3	160	27	91	90	68.5	15.0	6.30

Model: HGE

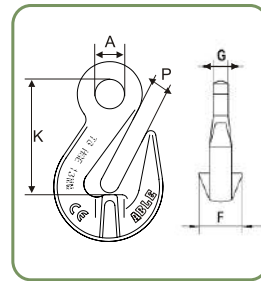

Alloy Eye Grab Hook Grade 80 Type: HGE

Product Code	For GR80 Chain Dia. (mm)	P mm	A mm	G mm	K mm	F mm	WLL 4:1 Ton	Weight kg
HGE 006	6	8	13	8	51	21.5	1.2	0.20
HGE 008	7,8	10	18	9	60	30	2.0	0.30
HGE 010	10	13	20	13	80	46	3.2	0.65
HGE 013	13	16	25	15	100	57.5	5.4	1.30
HGE 016	16	19	30	20	106.5	72	8.2	2.10
HGE 020	18,20	24	37.5	23	140	74	12.5	4.40
HGE 022	22	27	44	26	165	90	15.0	8.20



ABLEFORGED ALLOY STEEL SLING HOOKS

The **Ableforged Sling Hook** is a versatile, general purpose hook suitable for most slinging applications and has the added advantage of safety latch kits, readily available, for converting it into an **Ableforge safety hook**.

Eye Sling Hook



The Spring is made of Stainless Steel Material to prevent rust

Model: HES

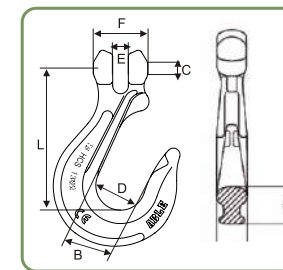
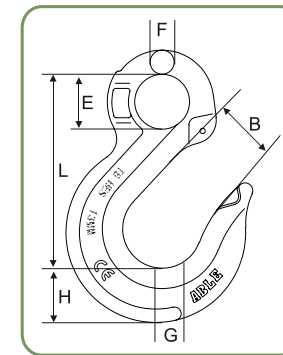

Technical Specialities

- Material is forged alloy steel (quenched and tempered)
- Large throat opening
- Anti - fouling due to carefully designed contours.
- Used with alloy chain grade 80 and wire rope for lifting application
- Embossed with ABLE, traceability, WLL, Batch Number and Size
- 100% 2.5 times of capacity proof load tested
- Ultimate load is 4 times of capacity
- Fatigue rated is 1.5 times the WLL at 20,000 cycles

ALLOY EYE SLING HOOK GRADE 80 TYPE: HES

Product Code	For GR80 Chain Dia. (mm)	L mm	B mm	E mm	F mm	G mm	H mm	WLL 4:1 Ton	Weight kg
HES 006	6	80	20.5	20	9	13.5	19	1.2	0.3
HES 008	7,8	98	26	25	11	18	24	2.0	0.4
HES 010	10	120	26	38	15	22	32	3.2	0.9
HES 013	13	152	39	43	19	32	42	5.4	2.0
HES 016	16	185	40	50	23	36	46	8.2	3.0
HES 020	18,20	219	43	62	24	42	58	12.5	5.8
HES 022	22	241	68	62	32	44	75.5	15.0	9.2
HES 026	26	279	82	64	35	60	88	20.6	13.1

ALLOY CLEVIS SLING HOOK GRADE 80 TYPE: HCS

Product Code	For GR80 Chain Dia. (mm)	L mm	B mm	C mm	D mm	E mm	F mm	H mm	WLL 4:1 Ton	Weight kg
HCS 006	6	76	26	7.6	35	8.0	32.0	20.5	1.2	0.35
HCS 008	7,8	94	29	9.0	37	9.5	37.0	22.0	2.0	0.56
HCS 010	10	111	39	12.7	46	13.0	49.0	29.5	3.2	1.07
HCS 013	13	139	47	16.0	56	16.5	56.5	38.0	5.4	1.88
HCS 016	16	163	55	21.0	60	18.5	74.0	48.6	8.2	3.47
HCS 020	18,20	198	61	24.0	79	24.0	81.5	71.0	12.5	7.42

Clevis Sling Hook



Clevis opening only allows correct size of chain to be fitted. Latch incorporated to provide additional lifting safety and the spring is made of Stainless Steel Material to prevent rust.

Model: HCS