

Model: BC



UNIVERSAL BEAM CLAMP

- Conforms to ANSI/ASME safety standard
- Can be easily adjusted with threaded handle
- Clamp jaw is designed to reduce flange stress by distributing load away from I-Beam flange edge
- Fits a wide range of flange width and beams
- Suspension bar provides lower headroom

OPTIONAL EXTRA

- Can be supplied without Lifting Ring
- Special design with flattened, reinforced jaws

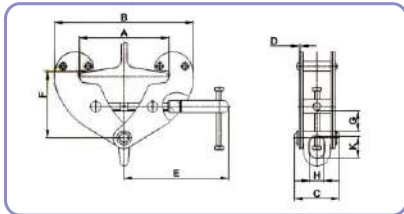

Product Code	Capacity (ton)	flange width (mm)	Dimensions(mm)											N.W. (Kg)
			A Max.	B Min.	B Max.	C	D	E	F Max.	F Min.	G	H	K	
BC1	1	75-230	240	192	367	94	4	218	155	103	20	30	45	4.0
BC2	2	75-230	240	192	367	102	6	218	155	103	20	30	45	4.8
BC3	3	80-320	330	243	491	132	8	258	223	157	47	45	63	9.8
BC5	5	80-320	330	243	491	142	10	258	223	157	47	45	63	11.1
BC10	10	90-320	330	259	501	180	12	293	235	175	56	64	95	17.8